

Quattro® Nylon Plug

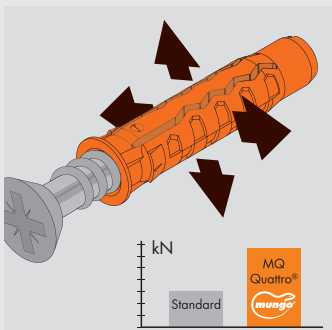

Quattro® Technology

Highest possible retaining values in the lower and middle load area. Particularly suitable for applications with chipboard screws.

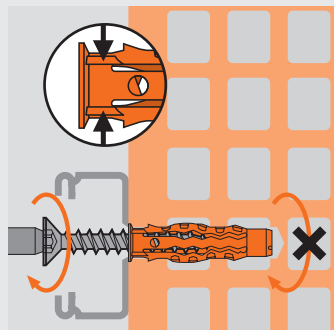

Rotation resistance

stops the plug rotating in the drill hole.

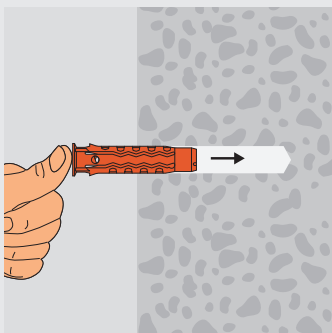

Reduced assembling time

Special plug geometry allows ease of entry into the drillhole.

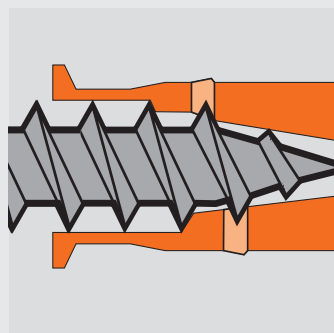

Knock-in protection

Prevents premature expansion while installing.



MQ Quattro® Nylon Plug



Features

- For use in all kinds of building materials
- Thanks to the collar controllable fixing
- Made from high-quality polyamide PA6
- Face fixing

Applications

holders, electric switches, pictures, lamps, profiles, under-constructions, rails

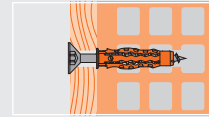
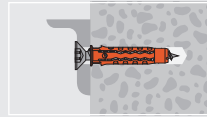

Technical Data

	Concrete C20/25 tension load (kN)	Brick tension load (kN)	Aerated Concrete tension load (kN)	Sandstone tension load (kN)	Perforated Brick tension load (kN)
MQ 5	0.45	0.45	0.12	0.45	¹⁾ 0.15
MQ 6	1.10	0.90	0.12	0.70	¹⁾ 0.20
MQ 8	1.2	1.00	0.19	1.00	¹⁾ 0.40
MQ 10	1.9	1.10	0.30	1.80	¹⁾ 0.45
MQ 12	2.7	1.50	0.40	2.10	0.50
MQ 14	3.0	1.80	0.55	2.30	0.60

Reached with max. diameter wood screw / Safety factor 5 / 1 kN Δ 100 kg / 1) Chipboard screw

Installation

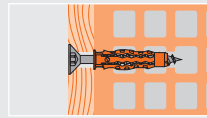
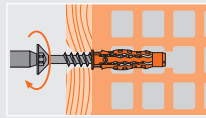
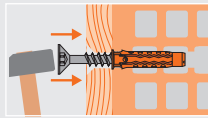
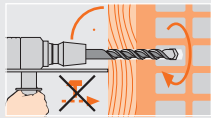

Article code	Plug and drill \varnothing mm	Length mm	Screwtype wood/chipboard \varnothing mm	Screwtype metric \varnothing mm	Box contents FS	Outer carton SK
1050050	5	25	2.6-4	M3	100 $\frac{1}{2}$	3600 $\frac{22}{22}$
1050060	6	30	3.5-5	M4	100 $\frac{1}{2}$	3600 $\frac{22}{22}$
1050080	8	40	4.5-6	M5	100 $\frac{1}{2}$	3600 $\frac{32}{32}$
1050100	10	50	6-8	M6	50 $\frac{1}{2}$	1800 $\frac{32}{32}$
1050120	12	60	8-10	M8	25 $\frac{1}{2}$	900 $\frac{32}{32}$
1050140	14	70	10-12	M10	20 $\frac{1}{2}$	720 $\frac{32}{32}$

MQ Quattro® Nylon Plug



Article code	Plug and drill \varnothing mm	Length mm	Screw \varnothing mm	Screw length mm	Drive	Box contents FS	Outer carton SK
1380050	5	25	3.5	30	PZ2	100 $\frac{1}{2}$	3600 $\frac{22}{22}$
1380051	6	30	4.5	40	PZ2	100 $\frac{1}{2}$	3600 $\frac{32}{32}$
1380052	8	40	5.0	50	PZ2	50 $\frac{1}{2}$	1800 $\frac{32}{32}$
1380053	10	50	6.0	60	PZ3	25 $\frac{1}{2}$	450 $\frac{32}{32}$

MQ-S Quattro® Nylon Plug with countersunk screw Pozi



Article code	Plug and drill \varnothing mm	Length mm	Screwtype wood/chipboard \varnothing mm	Screwtype metric \varnothing mm	Unit contents
1380532	5	25	2.6-4	M3	3500
1380533	6	30	3.5-5	M4	2000
1380534	8	40	4.5-6	M5	1000
1380535	10	50	6-8	M6	500

MQ Quattro® Nylon Plug in Mini-Box, bulk packed



30x20x12.5 cm



Article code	Plug and drill \varnothing mm	Length mm	Screwtype wood/chipboard \varnothing mm	Screwtype metric \varnothing mm	Box contents FS	Unit contents
1050051	5	25	2.6-4	M3	100 $\frac{1}{2}$	5600
1050061	6	30	3.5-5	M4	100 $\frac{1}{2}$	5600
1050081	8	40	4.5-6	M5	100 $\frac{1}{2}$	2800
1050101	10	50	6-8	M6	50 $\frac{1}{2}$	1400
1050121	12	60	8-10	M8	25 $\frac{1}{2}$	700
1050141	14	70	10-12	M10	20 $\frac{1}{2}$	560

MQ Quattro® Nylon Plug in Maxi-Box



40x30x23.5 cm



Article code	Contents	Display contents
1000018	MQ 6x30 (64 FS x 100 pcs. = 6400 pcs.) MQ 8x40 (32 FS x 100 pcs. = 3200 pcs.) MQ 10x50 (32 FS x 50 pcs. = 1600 pcs.)	11200

MQ Display



43x30x170 (43x30x71) cm

